

Parallax Lookout Structure  
50-162690

This play equipment is recommended for children ages:  
5-12

Scale: 3/16" = 1'-0"  
This drawing can be scaled only when in an 11" x 17" format

Drawn By:

Date:  
9/28/2023

Quote Number:  
50-162690

**play&park**  
**structures**

A PLAYCORE Company

544 Chestnut Street  
Chattanooga, TN 37402  
800-727-1907 / www.playandpark.com

User Capacity

65-75

Critical Fall Height

9'-0"

ISO  
9001  
CERTIFIED

Play & Park Structures

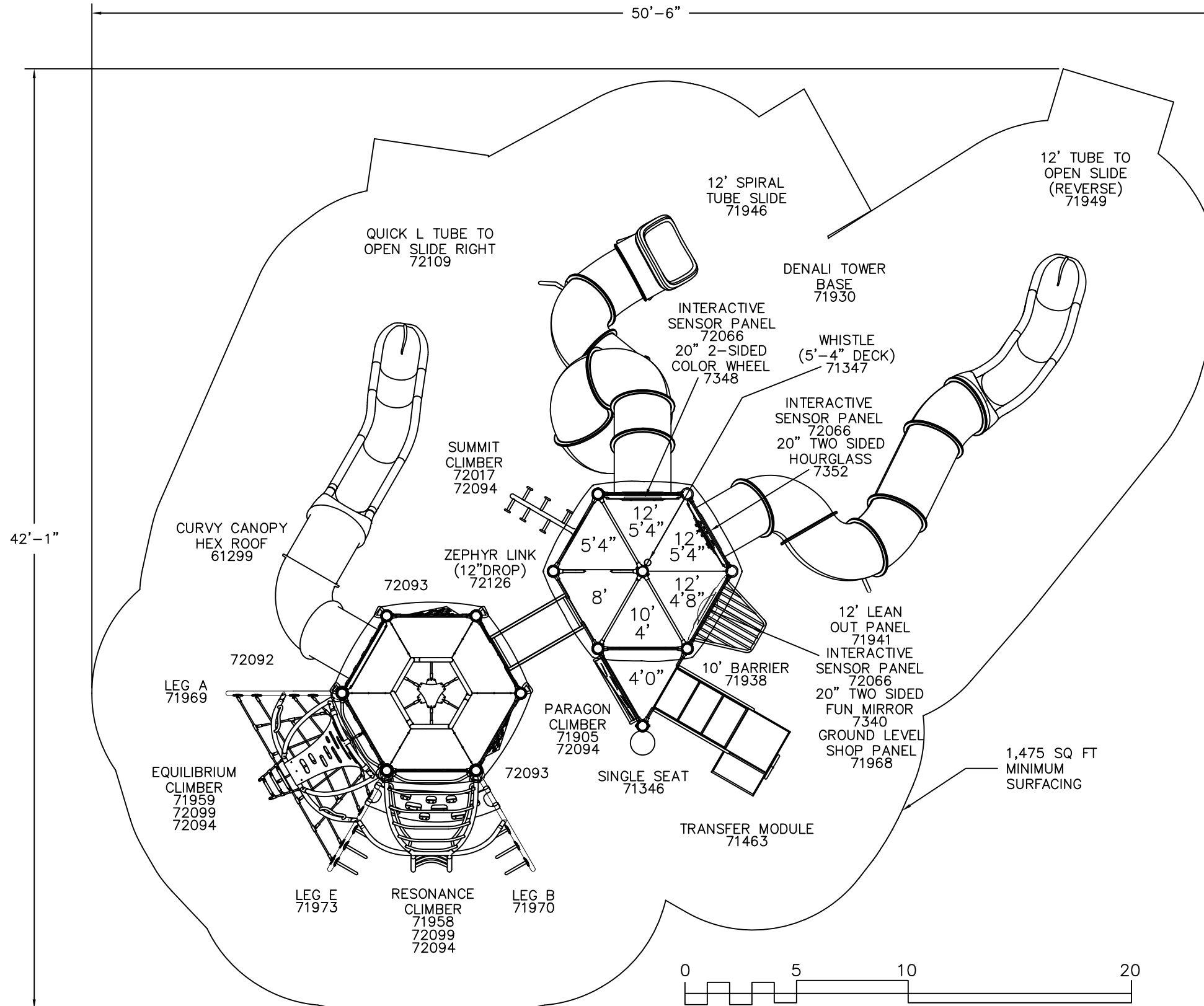

Top View drawings and measurements are for overall site and structure appearance purposes. Top view should not be conceived as a construction detail; therefore, all measurements and slope requirements should be field verified prior to construction.  
**IMPORTANT:** Never install play equipment over hard, unresilient surfaces such as asphalt, concrete, or compacted earth. It is the owner's responsibility to ensure the "minimum area required" contains an appropriate amount of resilient material to cushion accidental falls.